

- ◆ **Advanced manageability due to AC technology.**
- ◆ **The ergonomic boomerang control panel equipped with versatile visual display.**
- ◆ **Truck's design improves driver comfort, driving ease and visibility.**
- ◆ **Swing-open control cab design allows for quick and easy access to all components requiring routine inspection or adjustment.**

Operator compartment

- The Boomerang control panel and light steering controls enhance the ergonomic working position.
- All-in-one electronic display with integrated functions.
- Driver's cabin allows comfortable and secure driving position.

Chassis

- Easy access to service points due to swing-open cabin construction.
- Space for documents and accessories.

Drive unit

- Drive motor, steering motor and lift motor are all based on AC technology.
- AC technology improves handling and reduces need for maintenance. The drive motor is 5,5 kW.
- Electrical 360-degree steering.

Wheels

- Vulkollan drive and load wheels.



Mast

- Three-stage mast.
- Equipped with telescopic forks.

Electrical system

- The AC controller features versatile diagnostics.

Battery

- The battery compartment has a tiltable cover, which can be opened for simple checks and watering.
- Battery capacities 480-775 Ah/48 V.

Brakes

- Castor wheel brake as standard.
- Regenerative braking.
- Rapid braking is achieved by using the magnetic braking system.
- Automatic parking brake in addition to the normal hand brake.

Other options

- Battery-changing rollers.
- Operator radio with loudspeaker.

ROCLA BOOMERANG KK12

1	IDENTIFICATION		
1.1	Manufacturer		Rocla
1.2	Model		KK12
1.3	Power source		Battery
1.4	Operating mode		Sit-on
1.5	Nominal capacity/load	Q [kg]	1200
1.6	Load center (COG)	[mm]	600
1.9	Wheelbase (forks lowered)	y [mm]	2150
2	WEIGHTS		
2.1	Truck weight (with nominal load & battery)	[kg]	6740
2.2	Axle loadings (with load and battery), drive/load side	[kg]	2310/2020
2.3	Axle loadings (without load/with battery) drive/load side	[kg]	1710/1620
3	WHEELS & TYRES		
3.1	Tyres, material (Vul=Vulkollan) drive/load side		Vul/Vul
3.2	Load wheel dimensions (diameter x width)	[mm]	343 x 114
3.3	Drive wheel dimensions (diameter x width)	[mm]	350 x140
3.5	Number of the wheels (x=driven) drive/load side		1x /2
3.6	Track gauge (from the midpoint of the wheels) front wheels	[mm]	1240
4	DIMENSIONS		
4.2	Lowered mast height	h1 [mm]	4480*
4.4	Lift	h3 [mm]	9420*
4.5	Raised mast height	h4 [mm]	10950*
4.7	Height of the overhead guard	h6[mm]	2175
4.15	Fork height, fully lowered	h13 [mm]	380
4.19	Overall length (platform up/down)	l1 [mm]	2600
4.21	Chassis (overall width)	b1 [mm]	1440
4.22	Fork dimensions (thickness/width/length)	s/e/l [mm]	62/180/1200
4.25	Outside width over forks	b5 [mm]	550
4.29	Stroke, sideways	b7 [mm]	1350
4.31	Ground clearance	m1 [mm]	30
4.33	Working aisle width	Ast [mm]	1500
4.35	Turning radius	Wa [mm]	2400
5	PERFORMANCE		
5.1	Travel speed, laden/unladen	[km/h]	9,5/10
5.2	Travel speed, outside aisle forks below 500mm/above 1200mm	[km/h]	max/2.5
5.3	Travel speed, inside aisle forks below 4000mm/above 4000mm	[km/h]	max/2.5
5.4	Lifting speed, laden/unladen	[m/s]	0,24/0,29
5.5	Lowering speed, laden/unladen	[m/s]	0,47/0,47
5.10	Service brake		Magn. brake
6	MOTORS		
6.1	Drive motor	[kW]	5,5
6.2	Lift motor	[kW]	9,1
6.4	Battery voltage/capacity	[V/Ah]	48/775
6.5	Battery weight	[kg]	1100
8	MISCELLANEOUS		
8.1	Speed control type		Stepless

*With mast TR9800

Manufacturer reserves the right to make technical changes



Rocla Boomerang KK12

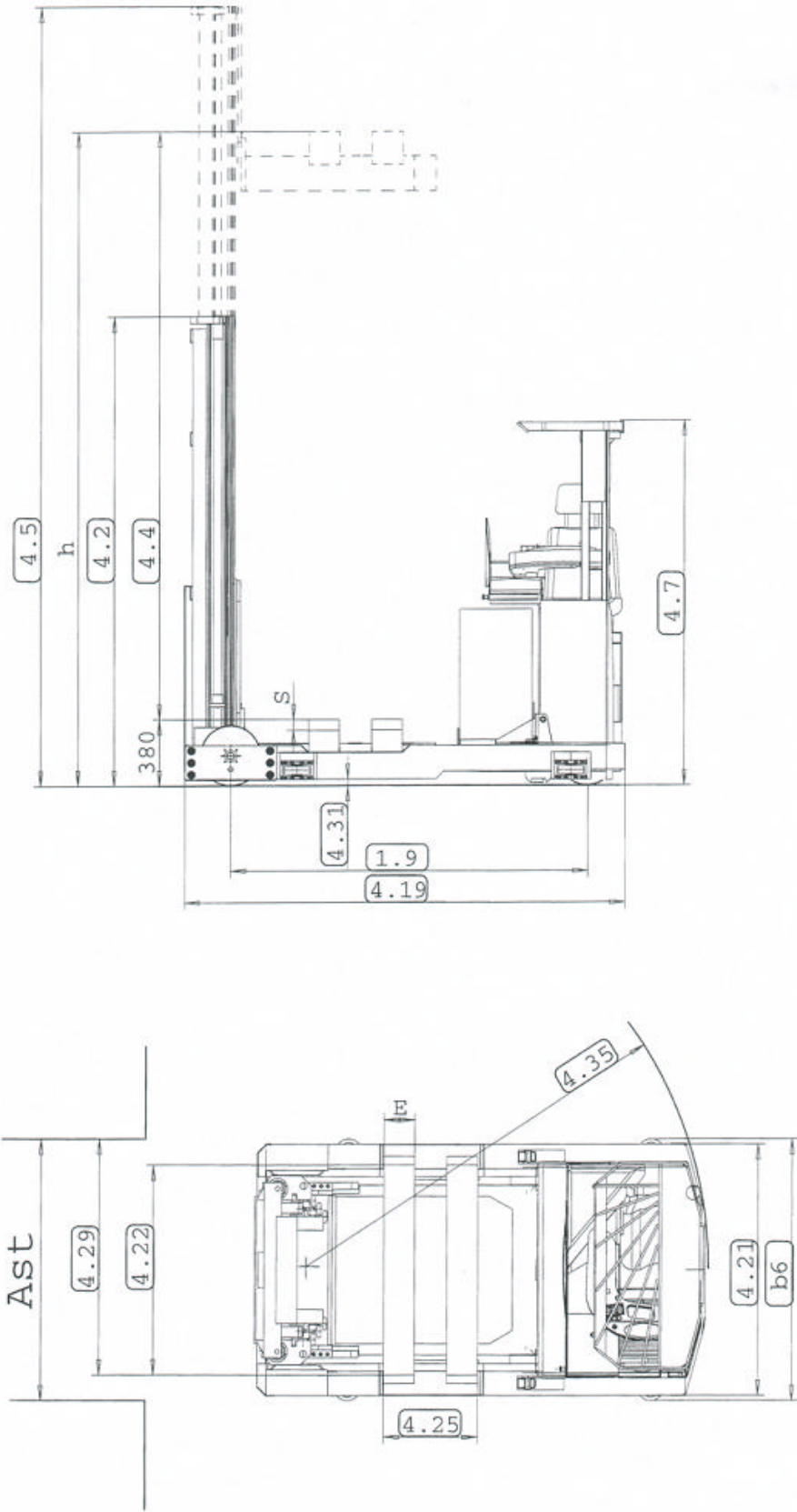

ROCLA BOOMERANG KK12

Mast options

Model	Mast	h3 Lifting height (mm)	h1 lowered mast height (mm)	h4 upper mast height (mm)
KK12	TRIPLEX (TR)	5000	2880	6150
		6000	3215	7150
		7000	3550	8150
		8000	3880	9150
		9000	4215	10150
		10000	4550	11150

Residual Capacity (with 600 mm load center, battery size 1300 kg)

Lift Height (mm)	Res. Capacity (kg)
6000	1200
8000	800
10000	600

Rocla Oyj
PO BOX 88, FIN-04401 JÄRVENPÄÄ

Tel. +358 9 271 471
Fax +358 9 2714 7440

www.rocla.com
E-mail: rocla@rocla.com

